

# XQ2

Owner's Manual

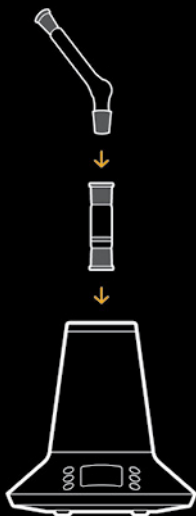

**MINI WHIP**  
Mini Fouet

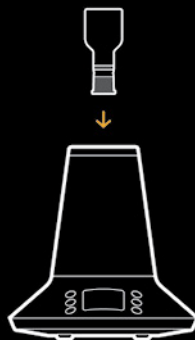

**AROMATHERAPY**  
Aromathérapie

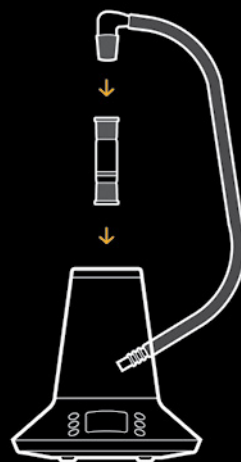

**WHIP**  
Fouet

Le informazioni contenute nel presente manuale sono fornite solo a scopo illustrativo e cautelativo, come aiuto alla comprensione delle diverse teorie e pratiche, preparazione e usi, e non rappresentano alcuna approvazione o garanzia di efficacia. Le presenti informazioni non intendono in alcun modo sostituire le consulenze professionali. Le informazioni qui contenute non intendono in alcun modo essere una guida medica o essere utilizzate per diagnosticare o trattare un problema di salute, una condizione o una malattia. È responsabilità dell'utente consultare un medico o uno specialista. Il prodotto non è concesso in licenza come dispositivo medico; utilizzare solo come previsto.

#### **Limitazione della responsabilità (leggere prima dell'uso)**

La mancata lettura o il mancato rispetto delle istruzioni, l'uso improprio o imprudente possono causare lesioni personali. Arizer e le società affiliate non assumono alcuna responsabilità per lesioni o danni derivanti dall'uso improprio di questo dispositivo. A causa della naturale fragilità del vetro, Arizer e le società affiliate non sono responsabili per tagli o lesioni subiti a causa di un'eventuale rottura delle parti in vetro. Arizer e le società affiliate non sono responsabili per lesioni o ustioni derivanti dal contatto con parti calde. Arizer e le società affiliate non sono responsabili per il mancato rispetto delle presenti avvertenze e linee guida sulla sicurezza. Se non sei d'accordo con queste condizioni, restituisci il prodotto immediatamente prima dell'uso.

Il prodotto è destinato all'uso con i prodotti vegetali qui descritti - Arizer e le società affiliate non sono responsabili per l'uso con altri prodotti. Le responsabilità della società per danni derivanti dal prodotto e dalle sue componenti non saranno superiori al prezzo di acquisto del prodotto.

**IMPORTANTE** - Rispettare la normativa locale. Non tutti i prodotti botanici e le erbe sono legali in ogni paese o stato. Prima di procedere all'acquisto dei prodotti botanici, controlla le leggi locali, statali, federali e sull'importazione. Il dispositivo è destinato esclusivamente all'uso legale.

#### **Certificazioni di sicurezza**

Destinato all'uso in tutto il mondo con una capacità da 110 a 240V e provvisto di certificazioni di sicurezza internazionali.



## PRECAUCIONES, AVISOS Y ADVERTENCIAS (LÉASE ANTES DE USAR)

Revise los contenidos del empaque para asegurarse de que todas las partes contenidas estén en buen estado y no hayan sido dañadas durante el traslado. Si algunas piezas presentan algún daño, no las use, y envíe un email a [service@arizer.com](mailto:service@arizer.com) para recibir asistencia. El material de empaque, bolsas y partes pequeñas pueden representar un riesgo de asfixia. Manténgalas fuera del alcance de niños, menores y mascotas. Antes del usar por primera vez, permita que el equipo caliente por 5 a 10 minutos a 220°C para eliminar cualquier residuo del proceso de empaque o manufactura. El equipo no debe usarse con líquidos destinados para cigarrillos electrónicos, ni con tabaco o cualquier producto derivado del tabaco. El mal uso puede dañar el equipo y viola todas las garantías. Cualquier servicio técnico no autorizado que reciba el equipo viola todas las garantías. Si requiere asistencia escriba a [service@arizer.com](mailto:service@arizer.com).

 **El equipo y sus partes calientes pueden representar un riesgo de quemaduras – Manéjese con precaución y cuidado**

- Nunca deje el equipo encendido y desatendido.
- Mantenga el equipo en posición vertical en todo momento.
- Permita que el equipo y sus partes calientes se enfrien antes de moverlo, guardarlo, o colocarlo sobre una superficie que pueda ser dañada por el calor.

 **El vidrio de borosilicato no es irrompible – Manéjese con cuidado y precaución**

- Evite golpear las partes de vidrio contra superficies rígidas para evitar quebraduras.
- No exponga el vidrio caliente a agua fría o cambios extremos de temperatura.
- Examine las partes periódicamente para detectar cuarteaduras, rajaduras o alguna debilidad del material debido a su manejo o caídas.
- Nunca use vidrio quebrado, rajado o roto.
- Deseche el vidrio dañado de acuerdo con sus regulaciones locales.

 **Este producto contiene componentes eléctricos – Manéjese con cuidado y precaución**

- No sumerja u opere el equipo dentro de o cerca de ningún líquido.
- No inserte o vierta nada al interior del equipo.
- No opere el equipo si éste ha sido dañado o expuesto a cualquier líquido.
- No guarde ni opere el equipo cerca de material inflamable o en temperaturas extremas.
- No abra el equipo; hacerlo puede derivar en una descarga eléctrica.
- Desconecte el equipo tomando y jalando firmemente el cuerpo de la clavija. No jale o tuerza el cable para desconectarlo.
- No permita que el cable toque superficies calientes.
- Posicione su equipo de tal manera que el cable no tenga riesgo de ser jalado accidentalmente o alguien pueda tropezarse con él.
- Si requiere utilizar una extensión eléctrica, utilice un cable aterrizado de tres contactos, con clavija de tierra física.

La información contenida en este manual es brindada únicamente para fines instruccionales y de precaución, como un apoyo para comprender las varias teorías y prácticas, preparaciones y usos, y no representa un endoso o garantía de la eficacia de su uso o su preparación. Esta información de ninguna manera debe reemplazar o substituir cualquier consulta o recomendación profesional. De ninguna manera la información aquí contenida debe interpretarse como una guía o recomendación médica, o utilizarse para diagnosticar o tratar cualquier condición de salud o enfermedad. Es responsabilidad del usuario consultar a un médico o profesional de la salud. Este producto no tiene licencia como dispositivo médico, utilícese sólo como se recomienda.

### **Limites de Responsabilidad (Léase antes de usar)**

El no leer o no seguir las instrucciones, así como el uso inadecuado o sin cuidado, pueden derivar en lesiones personales. Arizer y sus compañías afiliadas no asumirán ninguna responsabilidad por lesiones o daños originados a causa del uso o mal uso de este dispositivo. Debido a la fragilidad natural del vidrio, Arizer y sus compañías afiliadas no son responsables por algún corte o lesión a causa de su ruptura. Arizer y sus compañías afiliadas no serán responsables por lesiones o quemaduras asociadas a la manipulación de piezas calientes. Arizer y sus compañías afiliadas no son responsables de la falta de cumplimiento de todas estas advertencias y recomendaciones de seguridad. Si usted no está de acuerdo con estas condiciones, devuelva el producto inmediatamente antes de usarlo.

Este producto está diseñado para ser utilizado con los botánicos aquí descritos – Arizer y sus compañías afiliadas no son responsables del uso de otros botánicos adicionales a los aquí descritos. Las responsabilidades de la compañía a causa de daños relacionados con el producto y/o sus partes no podrán exceder el precio de compra pagado por el mismo.

**IMPORTANTE** – Obedezca las leyes locales. No todos los botánicos y hierbas son legales para uso en cada país o estado. Revise sus leyes locales, estatales, federales y de importación antes de comprar o usar sus botánicos. Este dispositivo está diseñado para uso legal exclusivamente.

### **Certificaciones de Seguridad**

Equipado para uso a nivel mundial con una capacidad eléctrica de entrada de 110-240V y certificaciones de seguridad internacionales.



**Cautions, Disclaimers AND Warnings (Read before use) 1**

Limitation of Liability (Read Before Use)

Safety Certifications

**What's Included 12**

**User Friendly OS 13**

Control Panel

Power

Settings

Fan

Navigation

**Remote Control 16**

Using the Remote

Power

Fan

Temperature Adjustment

Audio / Beep

Auto-Off Timer

LED Lights

**Operation 17**

Aromatherapy

Glass Connoisseur Bowl

Tuff Bowl Grips

Whip System

Balloon System

Balloon Assembly

**Cleaning and Maintenance 20**

Replacing the Air Intake Filter

**Warranty, Troubleshooting and Service 21**

## WHAT'S INCLUDED

- 1 x XQ2 Multi Purpose Heater
- 1 x XQ2 Power Adapter and Cord
- 1 x XQ2 Remote Control
- 2 x XQ2 Glass Connoisseur Bowls
- 2 x XQ2 Tuff BowlGrips
- 1 x XQ2 Glass Aromatherapy Dish
- 1 x XQ2 3' Whip (Silicone)
- 1 x XQ2 Glass Mini Whip w./ Dome Screen
- 1 x XQ2 Frosted Glass Balloon Mouthpiece
- 1 x XQ2 Balloon Connector
- 2 x XQ2 Balloon Bags
- 1 x XQ2 Balloon Cap
- 1 x XQ2 Air Filter Cartridge w./ Filter
- 1 x XQ2 Stainless Steel Stirring Tool
- 1 x XQ2 Flat Screen
- 1 x XQ2 Dome Screen
- 1 x Sample Aromatic Botanicals
- 1 x XQ2 Owner's Manual



ⓘ Sample Aromatic Botanicals not included in Australian package

## USER FRIENDLY OS

### Control Panel

- ① Power Button
- ② Settings Button
- ③ Fan Button
- ④ Navigation Buttons
- ⑤ Current Temperature
- ⑥ Set Temperature



## Power

Press the Power Button to instantly turn the unit on and off. Hold for 2 seconds to start the unit if the Delay Start setting is activated. The unit will beep once when turned On or Off when audio is activated.

## Settings

Press the Settings Button to access the menu and press the Up or Down buttons to navigate. When the desired Custom Session Setting is displayed, press the Settings button to select it, then press the Up or Down buttons to scroll through the options. When the desired option is displayed, press the Settings button to return to the menu, or wait 5 seconds to return to the temperature display.

### LED Lights

LED lights in the unit base and heater can be set to Off, Dynamic Mode, Spectrum Mode, or one of 8 individual color options. Spectrum Mode changes the color every 2 seconds in a continuous loop. Dynamic mode allows you to tell the state of the unit at a glance:

- **Heating:** Pulses from Yellow to Orange during heat up
- **Reach Set Temperature:** Blinks Green twice when set temperature is reached
- **Stable Temperature:** Pulses orange continuously while set temperature is maintained
- **Fan Operation:** Pulses purple when fan is active
- **Cooling:** Pulses cyan while the temperature is cooling down
- **Cooling with Fan:** Pulses blue while cooling with the fan activated.

### Screen Brightness

The color display has two brightness options: High and Low.

### Audio / Beep

This setting has three volume options: Low, High and Off.

### Temp. Alert

When this setting is activated, two beeps will be heard when the set temperature is reached. This option can also be turned Off.

### Auto-Off Timer

A programmable shut-off timer can be set at 30 minute intervals, up to 2 hours, and can be deactivated for longer use.

### Temp. Settings

The default display setting is Celsius, which can easily be changed to Fahrenheit.



### Delay Start

When this Setting is activated, the Power Button must be held for 2 seconds to turn on the unit. If the power button is not held, a double beep error warning will sound.

### Fan

Press the Fan button to switch between Low, Medium, High and Off. The Remote Control also has four dedicated buttons to change fan speeds directly.

### Navigation

The Up and Down buttons are used to navigate the menu settings and options, and to change the temperature settings directly. Press the Up or Down button once to change the temperature in 1-degree increments. Press and hold the Up or Down button to change the temperature in 10-degree increments.

## REMOTE CONTROL

### Using the Remote

The Remote Control gives direct access to frequently used Custom Session Settings and will quickly become your "go to" accessory. Before first use, ensure the plastic insert covering the battery has been removed.

### Power

Press to instantly turn the unit on and off. Hold for 2 seconds to start the unit if the "Delay Start" setting is activated.

### Fan

There are 4 dedicated fan buttons for Off, Low, Med, and High. Press the buttons to activate or change the fan speed.

### Temperature Adjustment

The Up and Down arrows are dedicated to adjusting temperature settings. There are three programmable temperature preset buttons. The preset button default temperatures are: (1) 170C/338F, (2) 185C/365F, and (3) 200C/392F. To reprogram the presets, set the temperature you would like to save, then press and hold the chosen button (1, 2 or 3) until you hear a beep.

### Audio / Beep

Press the Audio button to switch between the setting options.

### Auto-Off Timer

Press the Auto-Off Timer button to switch between the setting options.

### LED Lights

Press the LED button to switch between the Light setting options.



Remote Control

## OPERATION

### Aromatherapy

Botanicals such as Lavender, Chamomile, Orange Peels, and many more, can be vaporized for aromatherapy. By heating your favorite herbs and flowers to precise temperatures, the pleasing aromas, terpenes, and botanical compounds are released to promote/enhance energetic or relaxing environments.

1. Set the unit to a low temperature 100C – 150C (212F – 302F).
2. Place some dried botanicals into the Aromatherapy Dish.
3. Attach the Aromatherapy Dish to the unit
4. Turn on the fan to diffuse the aromas. Use fan speed 1 so the materials do not blow out of the bowl.
5. Discard the contents of the bowl and refill as desired.

⚠ **Do not pour liquids of any kind into the Aromatherapy Dish. Liquid damage is not repairable and is not covered under warranty.**

### Glass Connoisseur Bowl

The Glass Connoisseur Bowl has an optimized full-coverage air flow that evenly distributes heat for the most efficient use of flowers, herbs and botanicals, with two chamber sizes:

#### Cloud Chamber

Large capacity chamber with the glass screen closer to the heater. Produces a stronger/thicker vapor. Ideal for multi bag sessions.

#### Flavor Chamber

Small capacity chamber with the glass screen further from the heater. Produce a smoother/lighter vapor. Ideal for personal use and micro-dosing.

① **We recommend using the all-glass screen alone, but the flat metal screen can be added for finely ground materials.**

### Tuff BowlGrips

Heat-safe silicone Tuff BowlGrips can be used on both ends of the Connoisseur Bowl for easy handling.

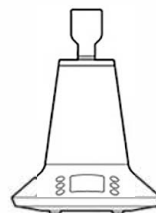

Aromatherapy



Cloud Chamber



Flavor Chamber



## LANGUAGE INDEX

- English 11
- French 22
- German 33
- Italian 44
- Spanish 55

## Whip System

1. Set the Unit to a higher temperature to suit your preference for light or thick vapor 170C-220C (338F-428F).

2. Coarsely grind the desired amount of material and load it into the top of the Connoisseur Bowl.

⚠ Do not load or pack the bowl too tightly or airflow could be restricted.

3. Attach the Glass Connoisseur Bowl to the unit, then attach the 3' Whip to the bowl. Wait for approximately 3-5 minutes to prime the materials for use.

4. Inhale through the glass mouthpiece in a slow, steady draw.

5. Alternately, turn on the Fan while inhaling for an assisted draw.

6. Periodically stirring the bowl contents will help get the most out of your material. Use the provided Stirring Tool to stir the material in the chamber. Remove the bowl from the unit before stirring.

7. Discard used bowl contents and refill as desired.

ⓘ The Dome Screen in the 3' Whip can clog and needs to be cleaned or replaced periodically for optimal performance.



Whip System

## Balloon System

1. Set the Unit to a higher temperature to suit your preference for light or thick vapor 170C-220C (338F-428F).

2. Coarsely grind the desired amount of material and load it into the top of the Connoisseur Bowl.

⚠ Do not load/pack the bowl too tightly or airflow could be restricted.

Always load from the top of the Bowl and never load both bowl chambers at the same time.

3. Attach the loaded Glass Connoisseur Bowl to the unit, then attach the mini-whip to the bowl. Wait for approximately 3-5 minutes to prime the materials for use.

4. Attach the balloon mouthpiece to the mini-whip.

5. Activate the Fan to your preferred speed and allow the balloon to fill with vapor.

6. Detach the balloon from the mini-whip, then inhale through the Frosted Glass Balloon Mouthpiece. Seal the balloon between draws using the silicone Balloon Cap to prevent leakage.

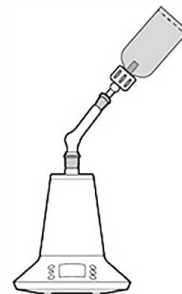

Balloon System

7. Periodically stirring the bowl contents will help get the most out of your material. Remove the bowl from the unit before stirring, and use the Stirring Tool to stir the material in the chamber

8. Discard used bowl contents and refill as desired.

① If the balloon is filling slowly or not filling, the bag may need to be replaced.

① The Dome Screen in the Mini Whip can clog and needs to be cleaned or replaced periodically for optimal performance.



Step 1

### Balloon Assembly

The Balloon consists of the Bag, Balloon Connector, Balloon Cap and Frosted Glass Balloon Mouthpiece.

1. Slip the silicone balloon cap over the glass mouthpiece so it rests between the glass bulbs.

2. Insert the bottom (unfrosted end) of the glass mouthpiece through the top of the hole of the silicone balloon connector. Push until the bulbs of the mouthpiece are on each side of the cap.

3. Gather the open end of the balloon and insert it through the large opening in the threaded base until there is enough material to fold evenly back past the base threads.

① The size of the bag can be adjusted by changing how much material is pulled through the opening. Trim excess material away with scissors.

4. Push the two pieces of the balloon connector together until they lock. Slide the connector up the glass until it rests against the bulb closest to the frosted mouthpiece.



Step 2



Step 3



Step 4

## CLEANING AND MAINTENANCE

Unplug unit from outlet before cleaning. Let the unit and all parts cool down before handling and/or cleaning. When cleaning any glass DO NOT expose hot glass parts to cold water or extreme temperature change, as this will cause cracking and breaking of the glass.

All parts/screens are removable for ease of cleaning. Regular Isopropyl Rubbing Alcohol, cotton swap, Pipe Cleaners, etc. can be used to clean/sterilize. Do not soak the tubing in alcohol as it may absorb the smell/taste. All glass and metal screens are safe to soak. When parts are clean, rinse thoroughly under hot water. Repeat as necessary. Make sure all the glass parts and accessories are fully dry before the next use.

If you experience difficulty removing the tubing from the glass parts, soak the tubing in hot water for a few minutes and the tubing will become softer and more pliable to work with.

To clean the warming unit and remote do not use any abrasive or hard cleaners, a simple soft cloth dampened (not wet) with warm water will do the job. Contact cleaner for keyboards and electronics can also be used.

If materials are spilled down inside the unit, turn the unit OFF and unplug. Turn the unit upside down and gently shake it back and forth until the debris falls out.

### Replacing the Air Intake Filter

To maintain optimal performance, periodically change the filter in the reusable Air Filter Cartridge.

1. Unplug the XQ2 and ensure that all parts have fully cooled.
2. Turn it upside down and pull the tab on the bottom of the unit to open the air filter compartment.
3. Remove the plastic Air Filter Cartridge by grasping the two finger holes.
4. Insert your finger in the large opening and pull off the perforated cover (exposing the white filter) and remove the old filters.
5. Insert the new black filter into the Cartridge, then place the second filter with white side facing out.
6. Replace the top of the Cartridge, ensuring the two tabs snap into place inside.
7. Place the Cartridge back into the bottom of the XQ2 with the two finger holes facing outward.
8. Close the air filter compartment cover by pressing the cover down until both tabs lock with an audible click.

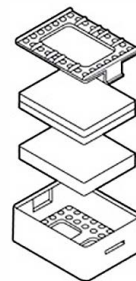

Air Filter

## WARRANTY, TROUBLESHOOTING AND SERVICE

- ① Fan speed may be noticeably different when the air filter is not being used. This will not have any bearing on temperature or vapor quality, only fill time for balloons.

### Replacing the Glass Heater Cover

If the internal glass part accidentally breaks there's no need to worry, it's easy to replace and replacement parts are available for purchase. Contact [service@arizer.com](mailto:service@arizer.com) for assistance.

### Warranty

The XQ2 carries a lifetime warranty on the heating element and a limited 3-Year warranty covering parts and labor costs against defects in materials or workmanship. Glass is not covered under warranty. Retain proof of purchase for warranty service. Warranty is non-transferrable, valid from the original date of purchase and does not extend or renew with service. Returning the product and costs incurred are the responsibility of the user. Arizer will repair or replace warranted items at our discretion. The warranty does not cover units damaged by dropping, tampering, unauthorized service performed or attempted, modifying the unit, misuse or abuse.

### Troubleshooting

If you experience an issue with your Arizer XQ2 send an email to [service@arizer.com](mailto:service@arizer.com) and an expert Arizer customer service representative will reply as soon as possible to help troubleshoot and resolve any issues. To expedite your service request please include a description of the problem, your full name, your shipping address, the serial number on the bottom of your device, and a copy of your sales receipt.

### Available Accessories

All Spare parts and accessories are available on our website: [www.arizer.com](http://www.arizer.com)





EST. 2016

# CANATURA

HEMP  LIFE

Canatura - Online store with the best  
hemp products for your health

[www.canatura.com/en](http://www.canatura.com/en)

Copyright reserved